

# 仿生機器人 萬獸之王組裝教學

講師：官田國中高瞻計畫團隊

必備工具

十字起子+翹子+萬能的雙手跟腦袋

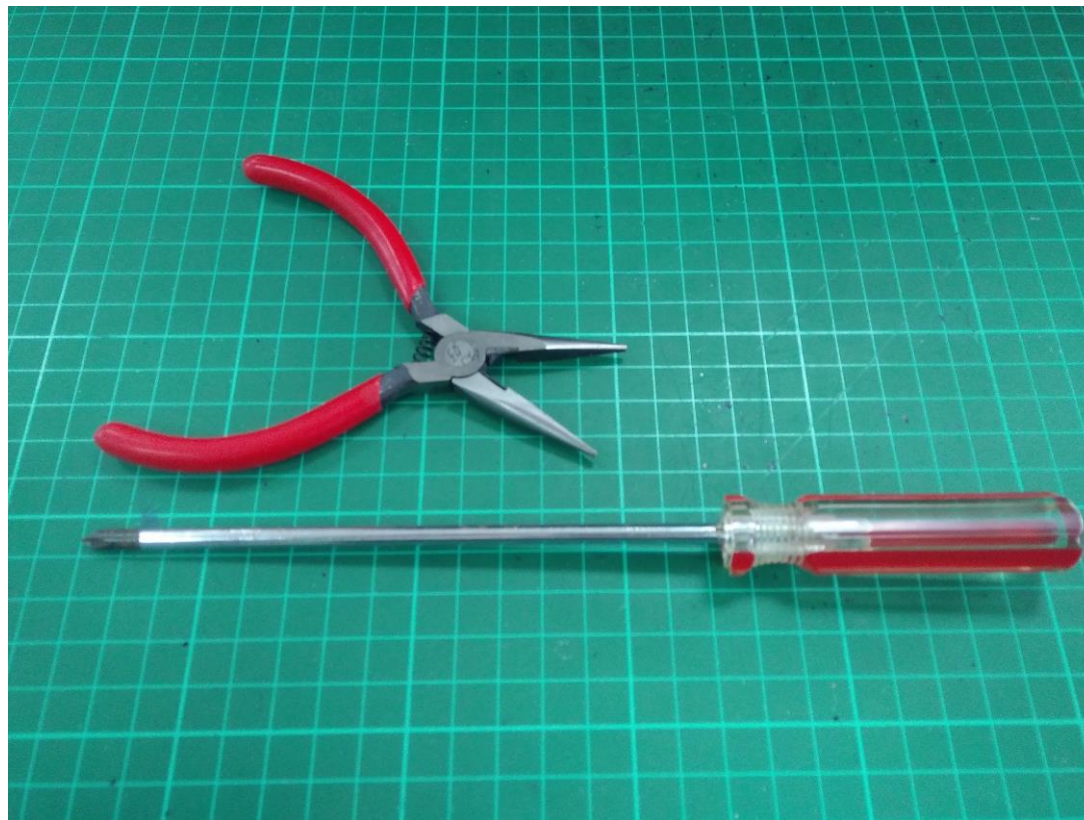

## 組合動力空盒

3螺絲釘鎖好，不歪掉，要上下剛好密合  
鎖不進去可以鬆開清除塑膠屑再重鎖

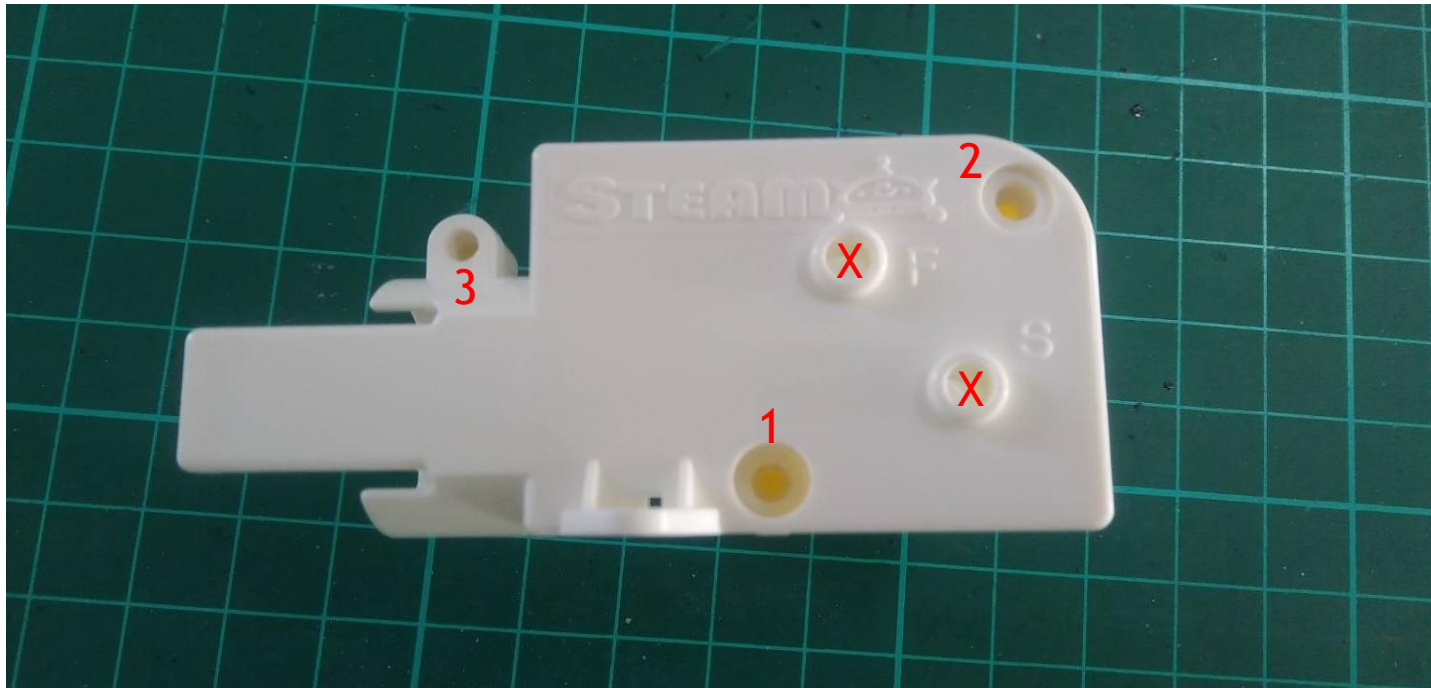

動力盒F+S檔位孔要塞入金屬環  
左右同時壓入塞緊即可，再拆開動力盒

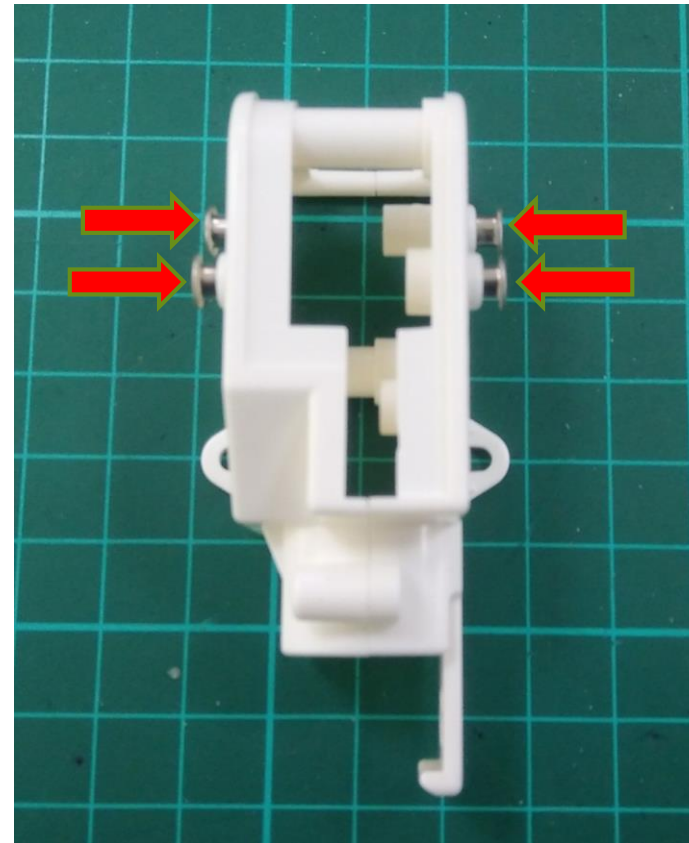
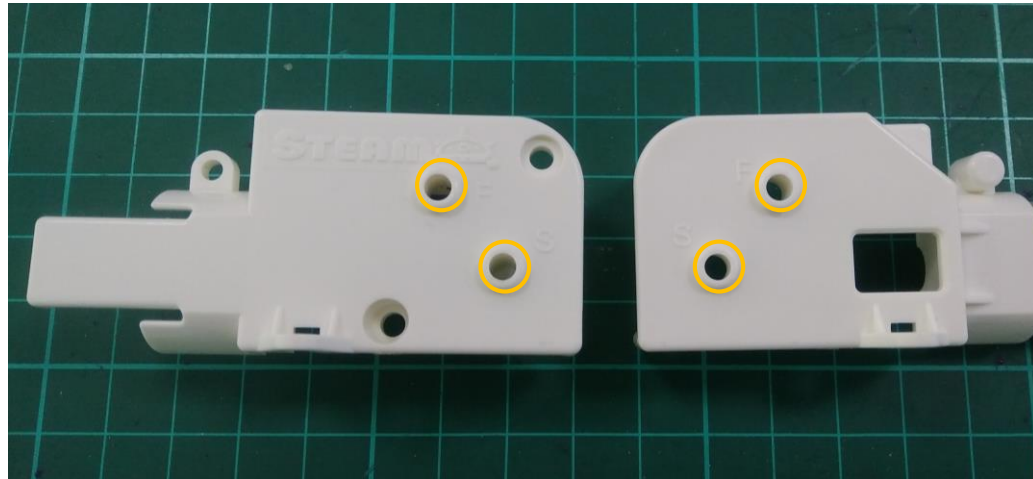

螺旋齒輪+馬達：有方型凸出朝馬達  
保留約**5mm**以上馬達軸芯，太短不易抽長

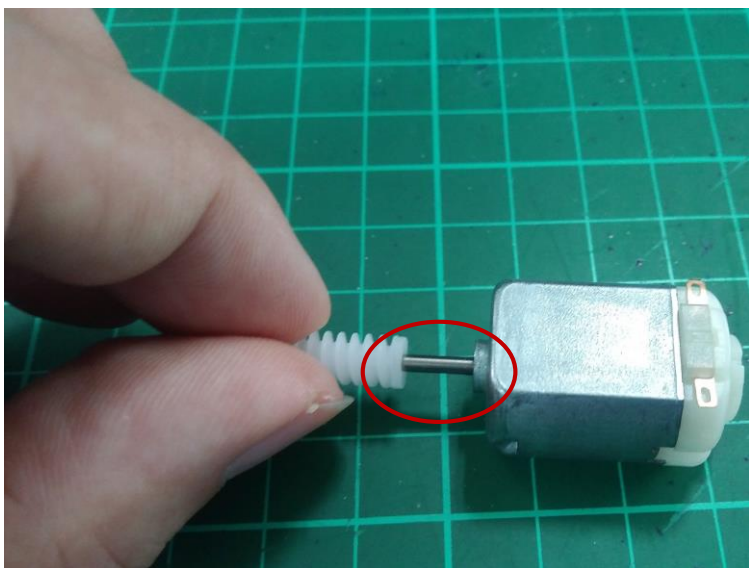
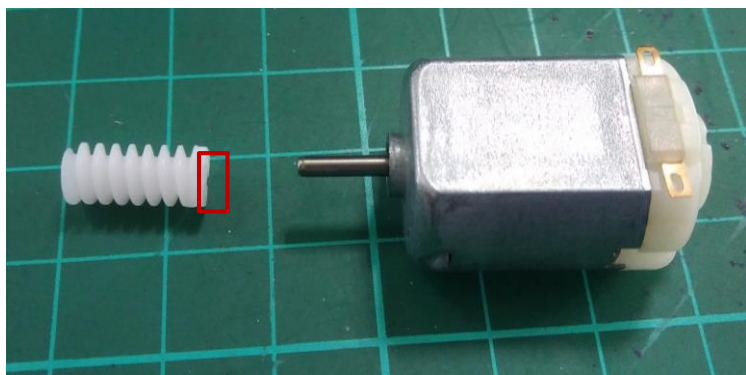

齒輪安裝：凸面及凸齒輪面朝上  
1.下(小顆)2.中(大雙凸)3.上(大顆)

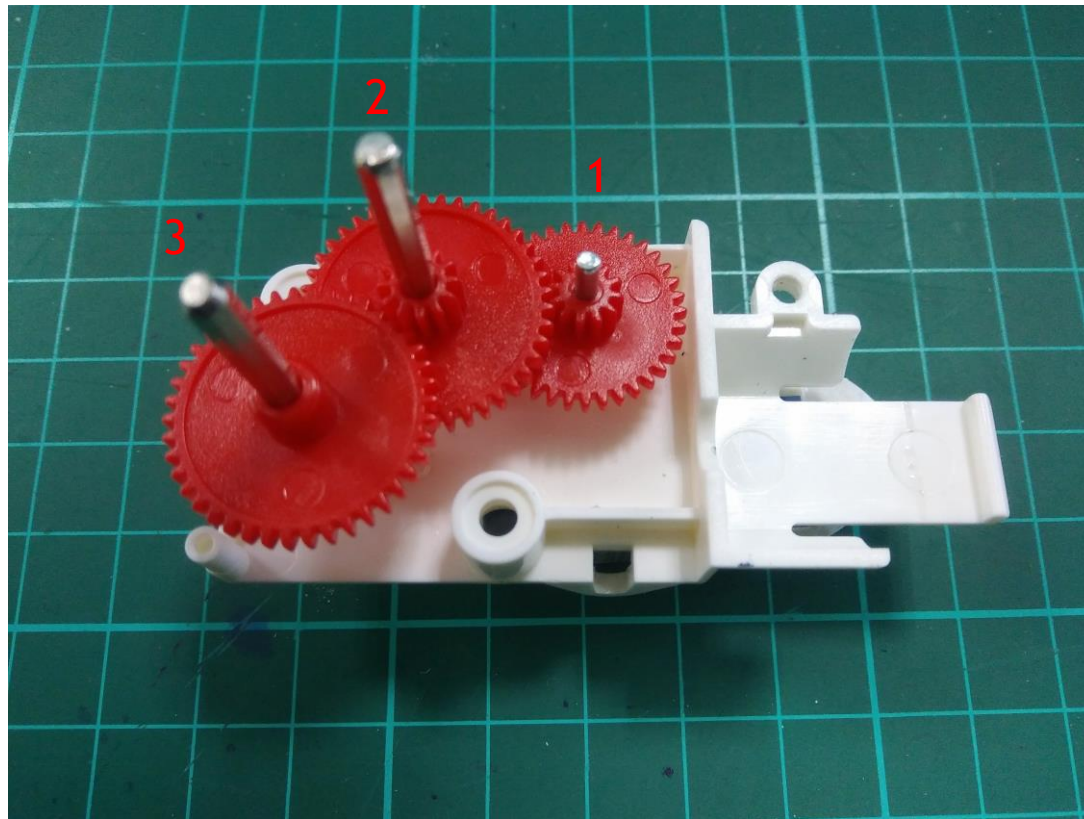

安裝馬達：電源接點朝上

螺旋齒輪太長卡到第2顆齒輪則壓短一些

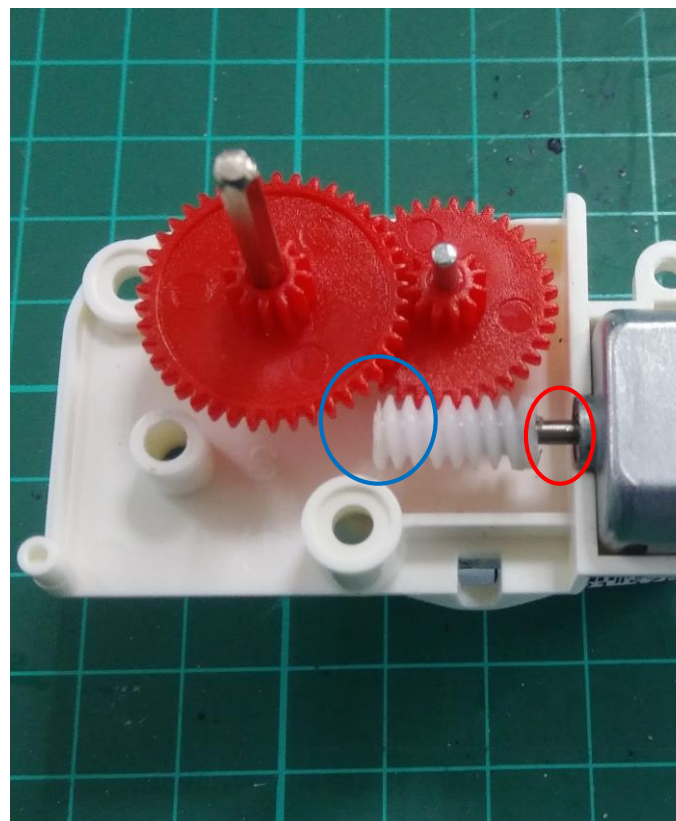
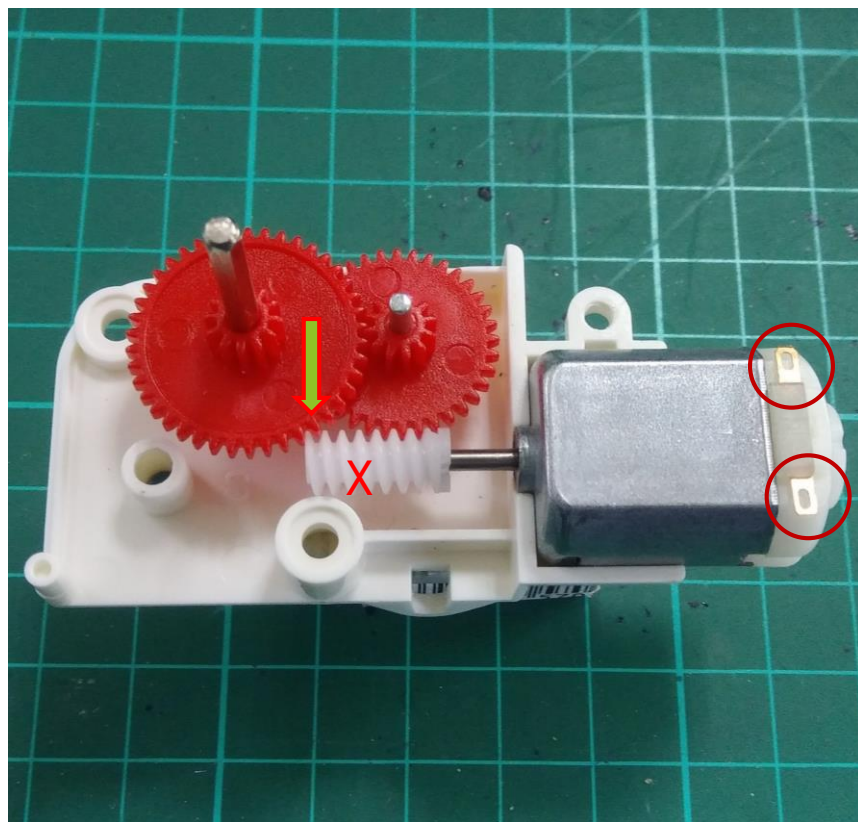

# 完成動力盒組裝

## 再把3螺絲釘鎖好鎖緊

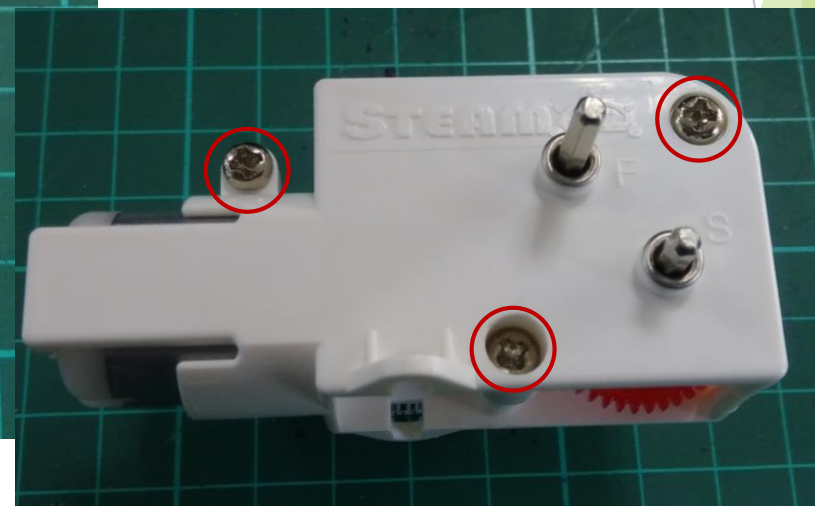
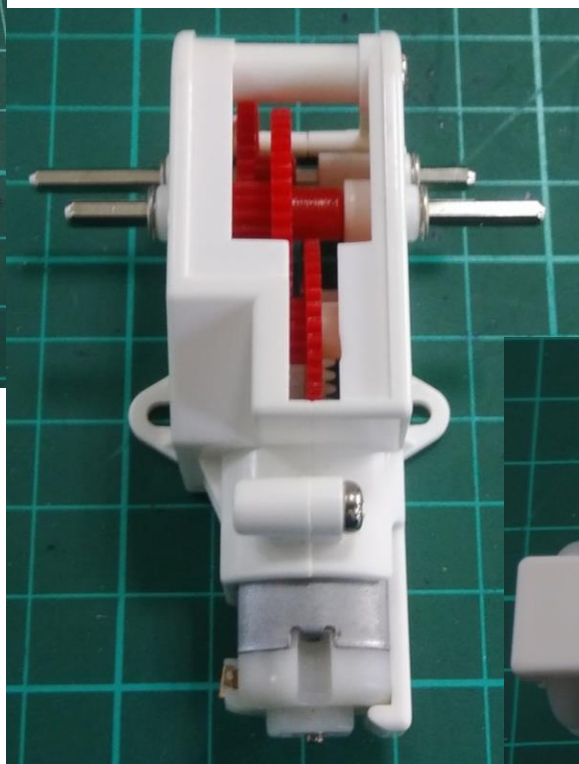



安裝左右連動旋轉臂：快速F檔(爬坡S檔)  
左3孔朝後，右3孔朝前

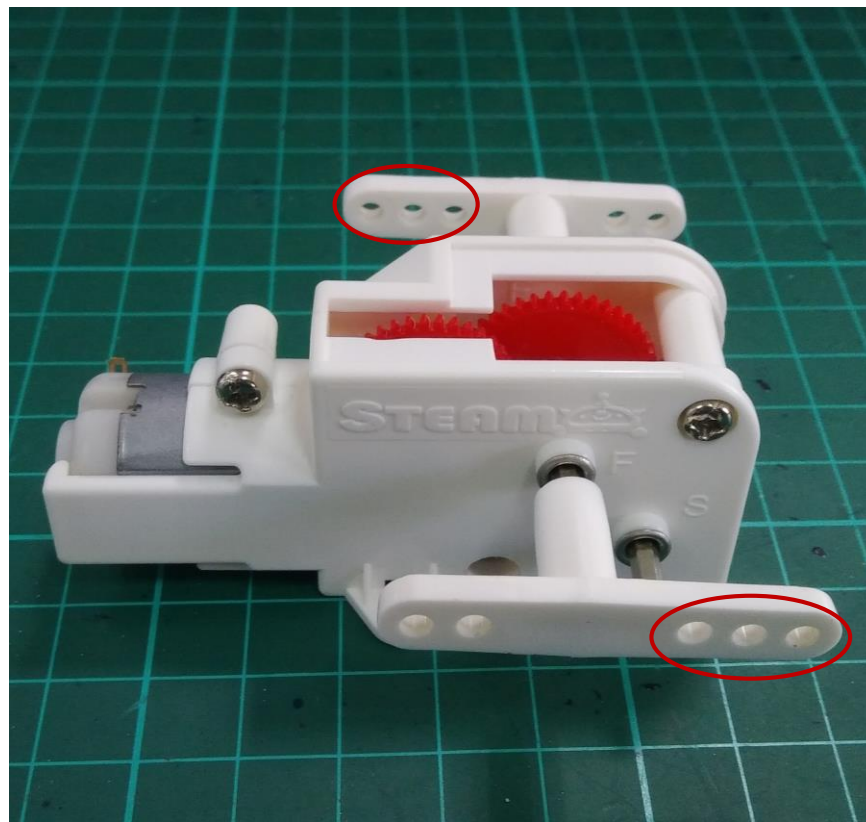
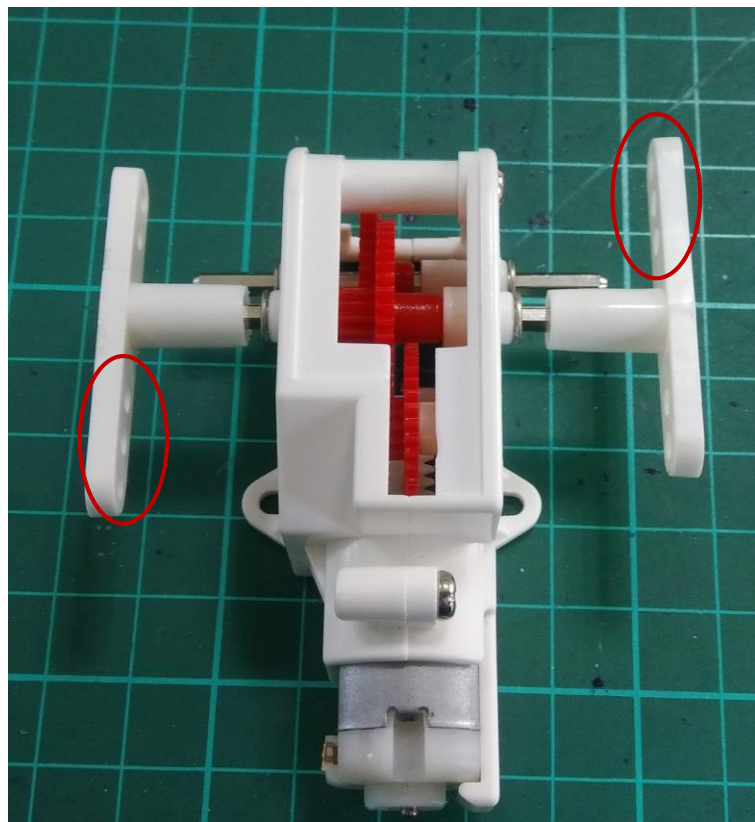

測試動力盒：電池先裝好並切到開啟，  
電線分別**接觸**馬達(要先**墊高**)

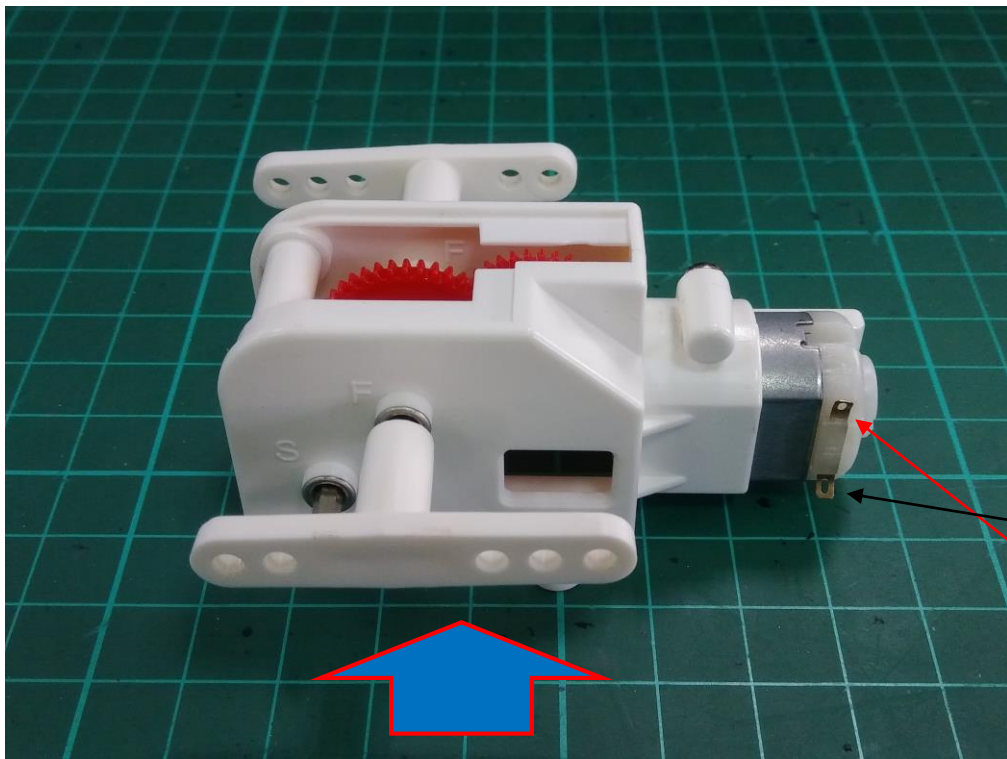

# 試運轉



# 後腳金屬固定軸安裝 束線帶頭凸出部份需朝外

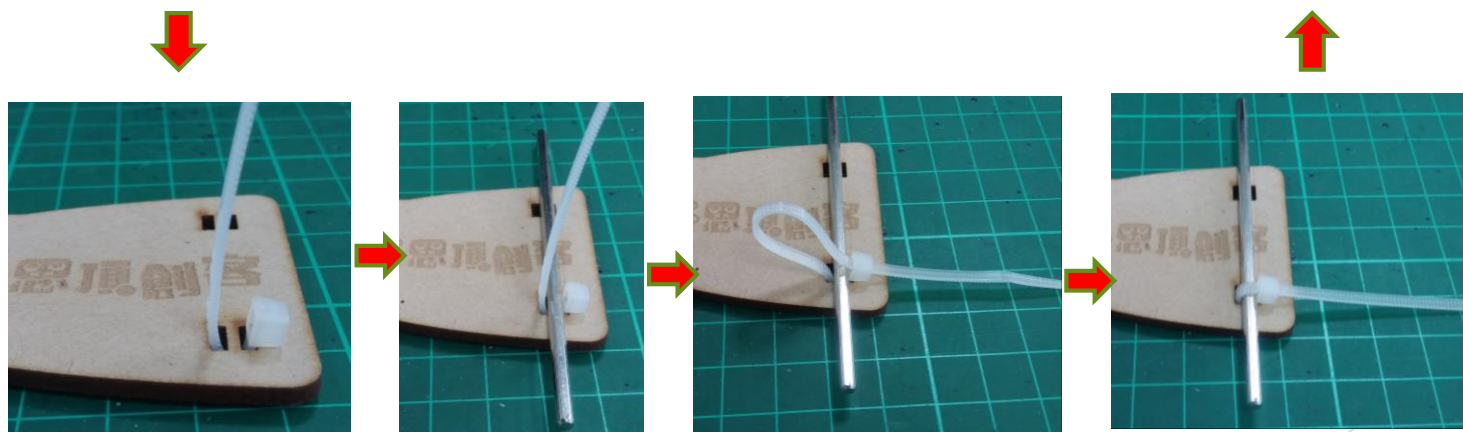

動力盒固定鎖緊在身體(用金屬螺帽)  
後腳固定軸芯左右齒輪固定(凸面朝內)

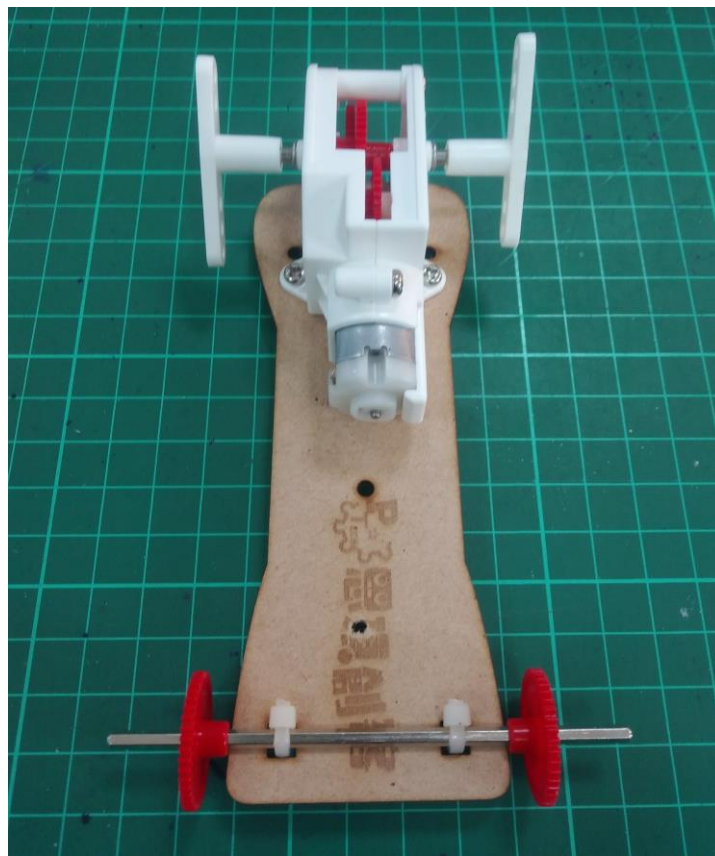

組裝後肢：固定軸芯穿出後腳中孔  
綠色軟螺帽壓入檔住(不可壓緊要能活動)

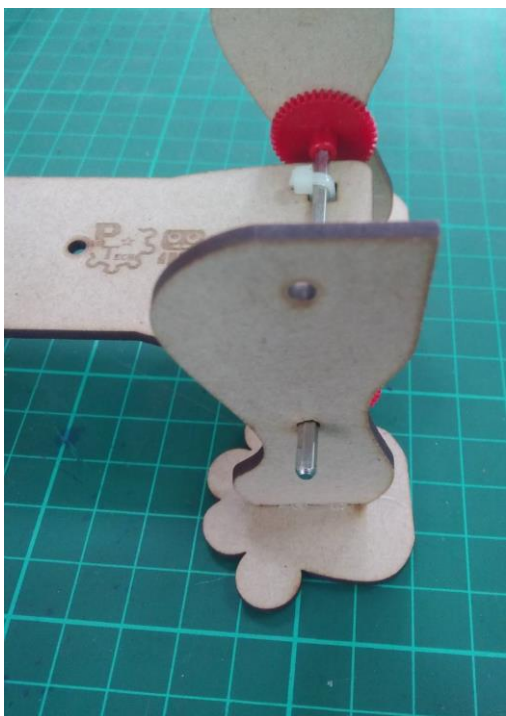

旋臂與前腿組裝：螺絲由內往外塞入  
注意對應孔(一律先找3孔的外側孔)

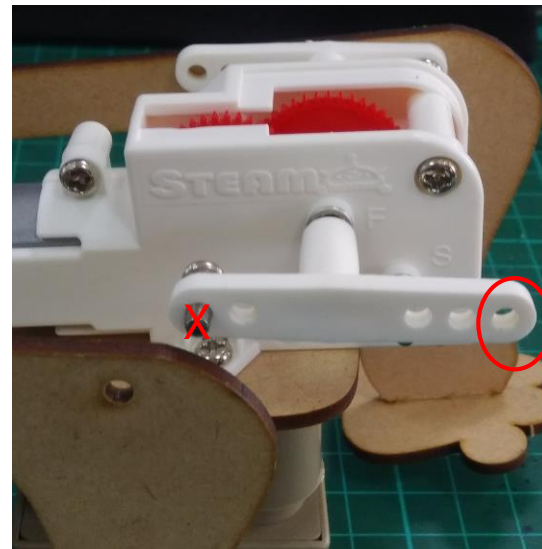
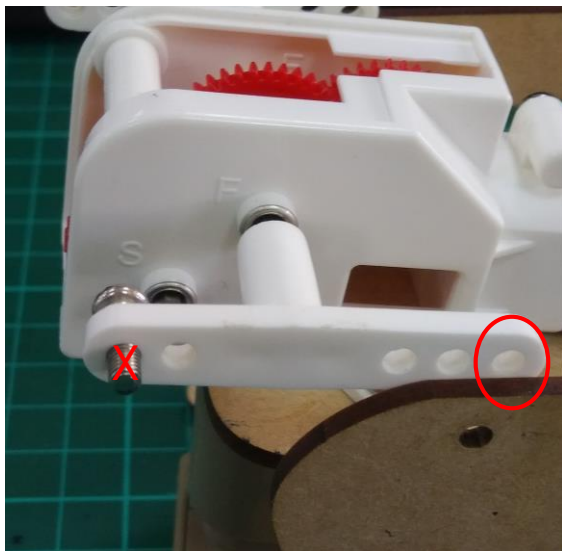

前腿連動後腿組裝：  
綠色軟螺帽旋入檔住(不可鎖緊要能活動)

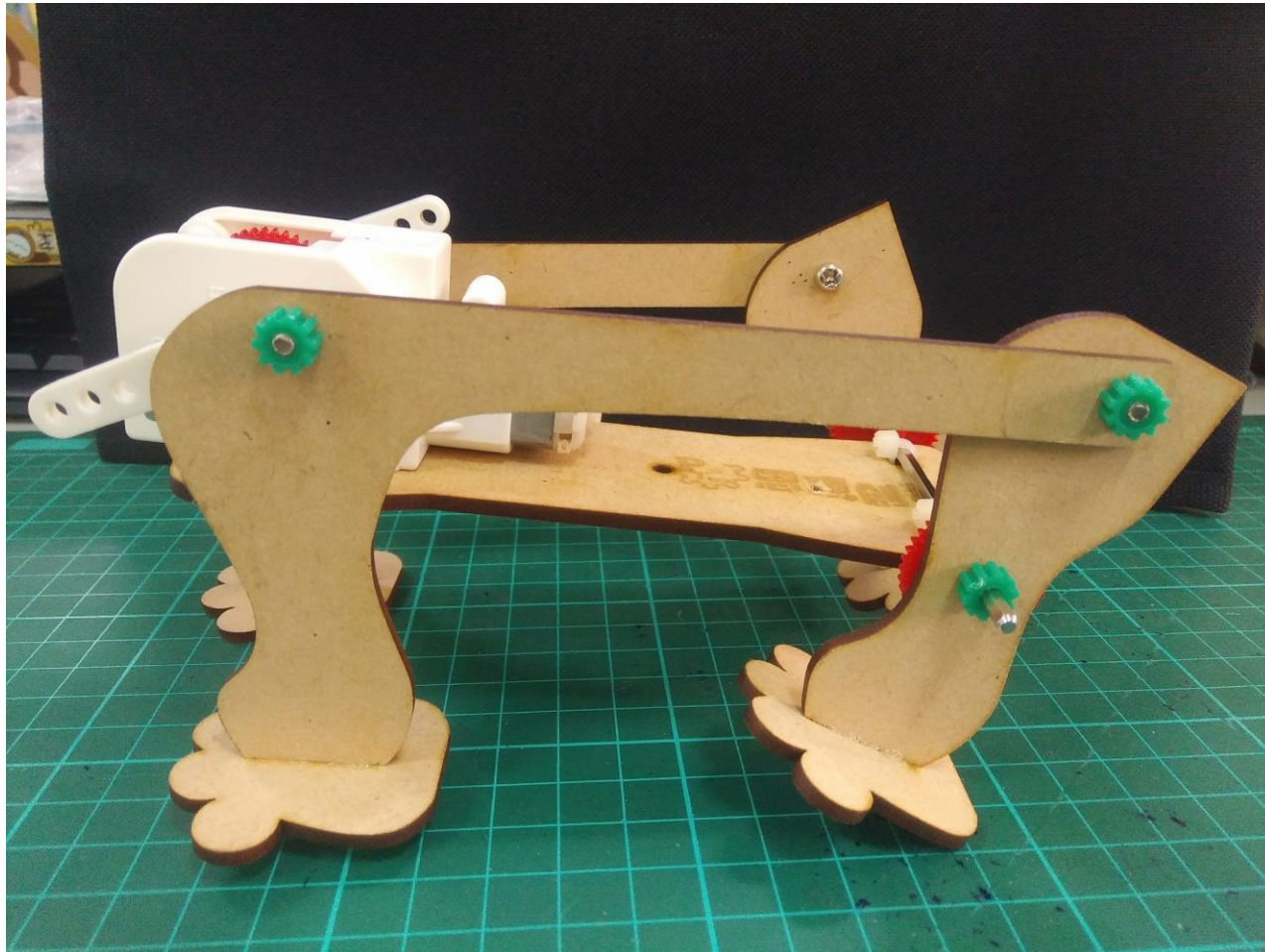



固定電池盒：建議放在下方較易接電源  
開關在中間以免卡到後腿，電線朝後

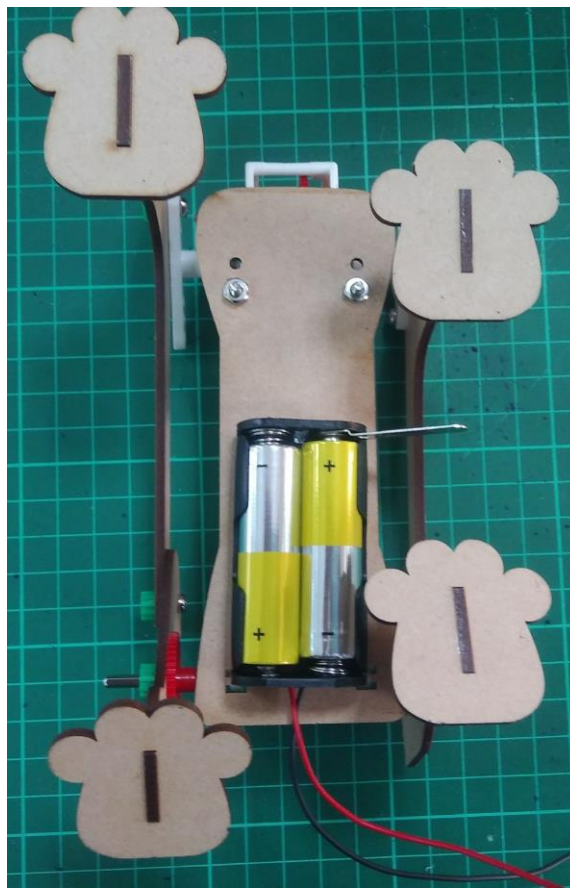
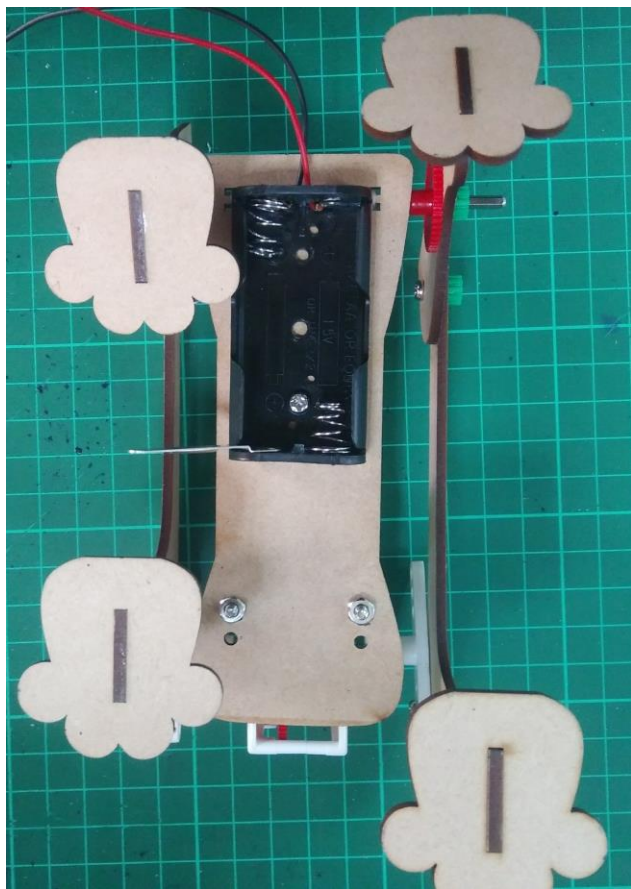

接上電源：電線從後面繞上來接(勾住就好)  
F檔時紅線接下面才是向前走

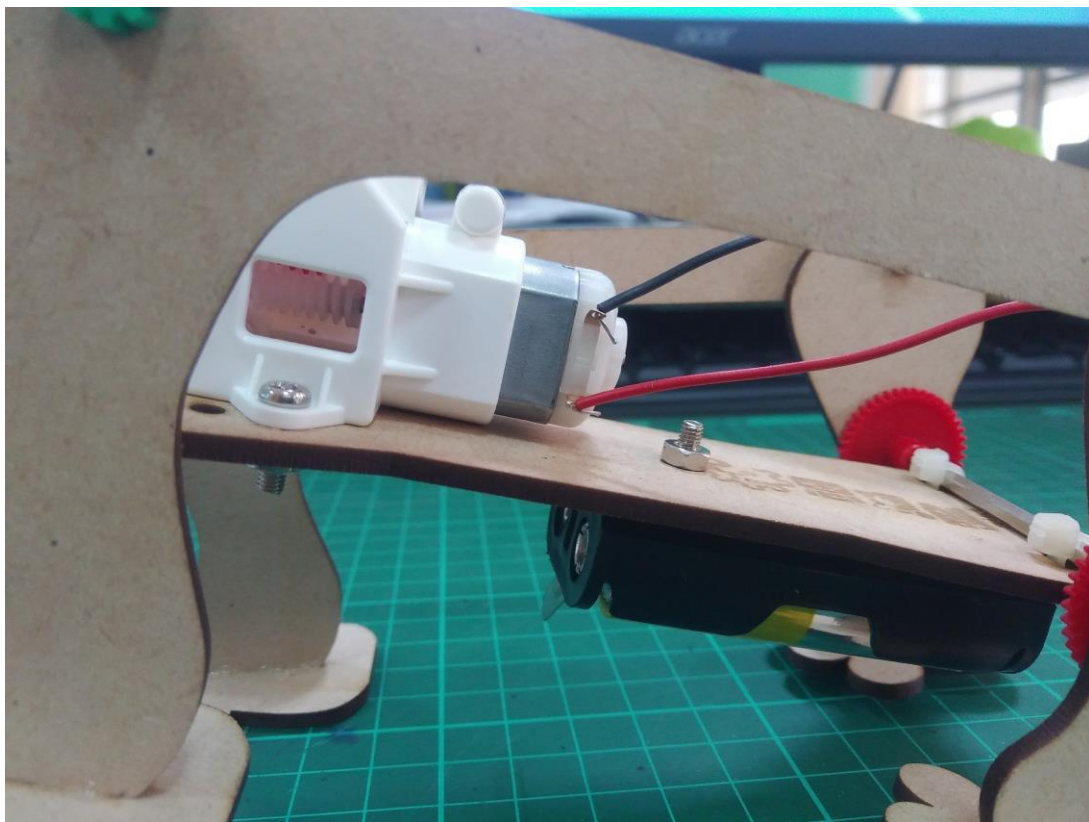

S檔時紅黑線要交換接

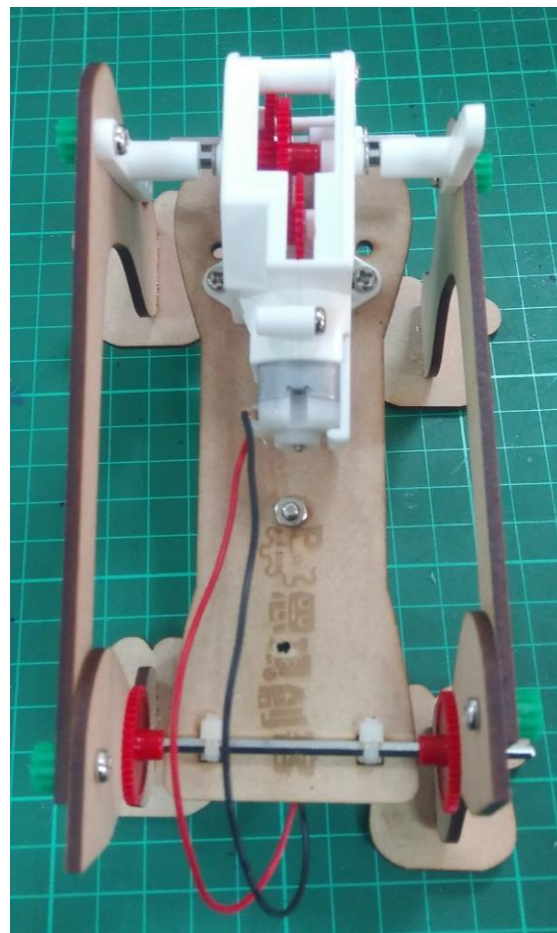

# 完工開玩

多1個綠色軟螺帽可寄鎖在螺絲凸出處

腳掌易脫落再用白膠或保麗龍膠黏合

爬坡不打滑腳底可加熱熔膠增加摩擦力

因應競速、爬坡、拉力賽，可自行變更檔位(F、S)及調整段速(對應孔)

身體亦可另行鑽孔，調整動力盒、電池盒固定的位置來配合檔位及段速

正式比賽沒有雷切好的身體及四肢，只提供冰棒棍跟一塊方形板，需自行手鋸及鑽孔



# 手鋸 萬獸之王

